

Jayco | 2025 Eagle HT Fifth Wheel



EAGLE HT FW

ADVENTURES AROUND EVERY BEND

2+3
YEAR | YEAR
WARRANTY





CLASSIC FARMHOUSE

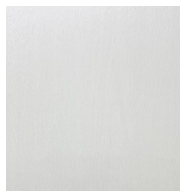

Main Wood



Accent Wood

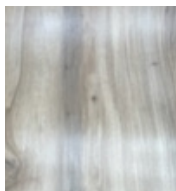

Floor



Countertop

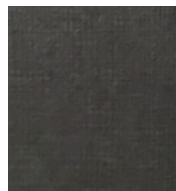

Main Fabric



Accent Fabric

EAGLE HT FW



25RUC OPTION: B

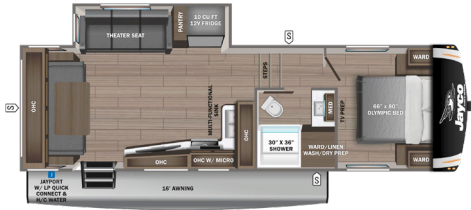

26REC OPTIONS: A, B, C

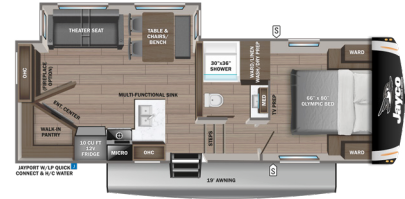

27MLC OPTION: C

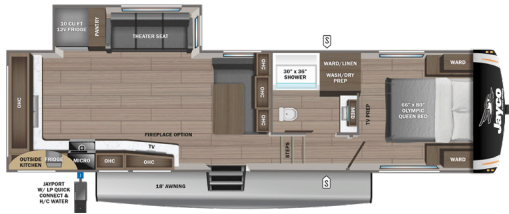

28CRT OPTION: A

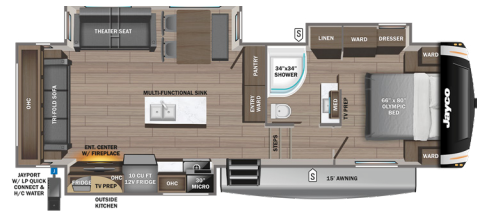

29CBD OPTIONS: D, E, F

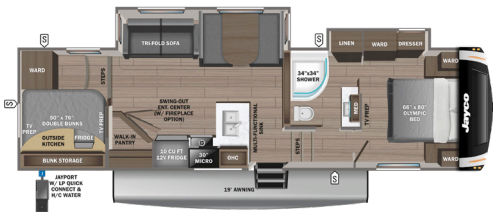

29DDB OPTIONS: C, F

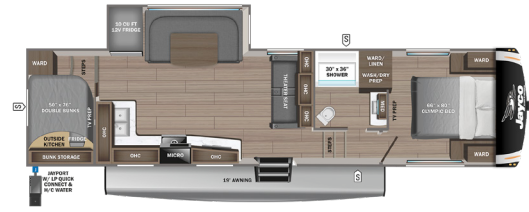

29RLC OPTIONS: A, B



30CRT OPTIONS: A, B



31MBT

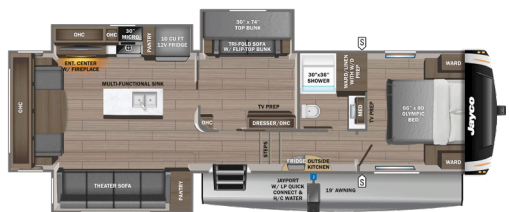

31QCD OPTIONS: C, F

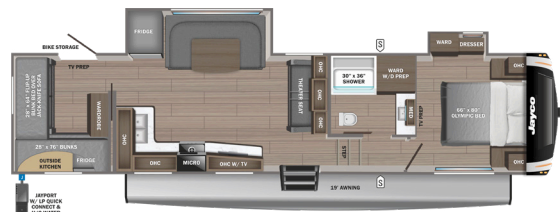

OPTIONS

A



Dinette

B



Griddle/Sink

C



Tri-fold Sofa

D



Table & Chairs/Bench

E



Theater Seat

F



Triple Recliner



STORAGE
MICRO MICROWAVE
OHC OVERHEAD CABINETS
FRIDGE REFRIGERATOR
WARD WARDROBE

STANDARDS & OPTIONS

EXTERIOR

1.5 in. fresh water drain valve
 5 in. Magnum Truss™ with plywood roof decking
 50-amp detachable power cord
 Additional dump valve at termination
 Alpha Ply TPO roof membrane (thickest roof membrane with limited lifetime warranty)
 Auto-grade vinyl graphics
 Automotive style front cap with max turn radius (painted on select models)
 Backup camera prep
 Black tank flush
 Climate Shield™ zero-degree tested weather protection:
 * Fully enclosed and heated underbelly (ducted)
 * 35,000 BTU furnace
 * Double layer fiberglass batt insulation in ceiling and floor
 * Double sided radiant barrier insulation (roof, floor and behind cap)
 * PEX plumbing
 Commercial grade rubber flooring in pass through area
 Dual 30 lb. LP bottles
 Factory installed roof ladder
 Galvanneal steel coated outside kitchens
 HELIX Cooling System™ (industry exclusive):
 * Jayco exclusive insulated dual duct design
 * Directional and closeable A/C vents
 * Larger return air vents with user accessible filters
 Independent satellite and cable hookups (outside kitchens and/or pass through storage areas)
 LED exterior lighting package
 LED light and switch at termination
 LED lighting in pass through area
 LP quick connect for gas griddle (next to JayPort)
 Metal slam latch baggage doors
 Nautilus 2.5 water connections
 Nitrogen filled under mount spare tire (model/option varies 15 in. or 16 in.)
 Overlander Solar Prep (Roof)
 Quick connect water connections (door side hot/cold and off door side cold only)
 Slide topper/awning prep
 Stronghold VBL™ walls (laminated sidewalls, rear walls and slide out walls)

INTERIOR

100% No Floor Vents
 2-piece high gloss bathroom surround
 5/8 in. tongue-and-groove plywood flooring
 75 lb. full extension drawer guides

Bathroom skylight
 Bedroom TV, satellite and cable prep
 CPAP prepped bedroom (both sides)
 Extra 120V power outlets in kitchen and slide rooms (where applicable)
 Gas strutted under bed storage
 Handcrafted and glazed door/drawer fronts
 Matte black kitchen faucet with pull-out sprayer
 NuVo H2O Water Treatment System (filters included)
 Porcelain foot flush toilet
 Residential vinyl flooring throughout (NO CARPET)
 Solid hardwood slide fascia
 Teak seat shower prep (select models)
 Theater seating (select models)
 Tri-fold hide-a-bed sofa with residential memory foam sleep surface (select models)
 USB 12V charging ports (multiple locations throughout)
 Water shutoff at all faucet locations

CUSTOMER VALUE PACKAGE (MANDATORY)

15,000 BTU "Whisper Quiet" A/C and bedroom A/C prep
 40 in. 4K Ultra LED HD Smart TV in living room
 50-amp service with dual A/C ducts
 60,000 BTU on-demand tankless water heater
 Custom machined aluminum rims
 Electric patio awning
 Exterior "Blue Sync" Audio Connect with MB Quart Sound (TV and phone)
 Hidden hinges on cabinet doors
 Interior "Blue Sync" Audio Connect with MB Quart Sound (TV and phone)
 Keyed-Alike™ lock system
 MORryde Step Above™ entrance steps (main entrance) with blue LED light
 Rain proof bathroom power vent
 Rear 2 in. towing receiver with 4-pin connector
 Upgraded friction hinge entrance door
 Winegard Air 360 + antenna and router prep (NOW 5G)

LUXURY PACKAGE (MANDATORY)

Blackout roller shades with reflective side throughout
 Electric auto-leveling
 GE 10 cu. ft. 12V refrigerator
 GE 30 in. over-the-range black and stainless microwave with exhaust fan

GE black and stainless 21 in. range with edge to edge grates
 Inverter pre-wire (multiple locations) ((7) 110 outlets) (6 USBs 12V)
 JayPort 2 in. mount (for outside accessories)
 Magnetic catches for all drawers and doors
 Multi-Function "ALL in ONE" Stainless steel kitchen sink
 Residential 66 in. x 80 in. Olympic size mattress
 Residential style glass shower door
 Washer/dryer prep (select models)

4-STAR HANDLING PACKAGE (MANDATORY)

Dexter® Axles with NEV-R-Adjust® brakes and E-Z Lube® hubs
 Goodyear® Endurance® tires (load range E)
 MORryde® CRE-3000™ rubberized suspension
 Wet bolt fasteners with bronze bushings

OPTIONS

15,000 BTU bedroom A/C
 16 in. Endurance® Goodyear® wheels/tires (select models)
 Dexter® ABS brake system with anti-sway
 Dry camping package (generator prep) (Extra LP capacity)
 Extreme Weather Package with 120 heat pads and 12V heat tape on fresh water line
 Free standing table with leaf and bench seat and 2 foldable Dinette chairs
 Furniture cup holder tables (1 pair)
 HALO 22 in. outside griddle with deep sink attachment for JayPort system (select models)
 JAYCOMMAND® Smart RV System with TPMS monitoring
 LED fireplace with 5,000 BTU electric space heater (select models)
 Overlander 1 Solar Package (200W panel and 30-amp solar controller)
 Overlander 2 Solar Package: (2) 200W panels, MPPT 30-amp solar controller and 1800W inverter)
 Triple Reclining Sofa ipo Dinette

*Indicates split tanks

FLOORPLAN	TOTAL EXTERIOR LENGTH	EXTERIOR WIDTH	EXTERIOR HEIGHT (WITH A/C)	INTERIOR HEIGHT (MAIN)	INTERIOR HEIGHT (UPPER DECK)	UNLOADED VEHICLE WEIGHT	DRY HITCH WEIGHT	GVWR	CARGO CARRYING CAPACITY	FRESH WATER CAPACITY	GRAY WASTE WATER CAPACITY	BLACK WASTE WATER CAPACITY	SLEEPING CAPACITY
25RUC	29' 9"	8' 1"	12' 11"	8' 5"	6' 3"	8,065	1,620	9,650	1,585	52	82*	45	2-4
26REC	29' 4"	8' 1"	13' 0"	8' 5"	6' 2"	8,000	1,640	9,750	1,750	52	82*	45	4-6
27MLC	32' 10"	8' 1"	12' 6"	8' 5"	6' 2"	8,525	1,740	10,300	1,775	52	82*	45	2-4
28CRT	32' 11"	8' 1"	12' 6"	8' 5"	6' 3"	9,515	1,960	11,350	1,835	52	82*	45	2-4
29CBD	34' 8"	8' 1"	12' 11"	8' 5"	6' 2"	9,525	2,075	11,450	1,925	52	82*	45	6-8
29DDB	34' 7"	8' 1"	13' 0"	8' 5"	6' 2"	8,995	2,375	10,750	1,755	52	82*	45	4-6
29RLC	34' 1"	8' 1"	12' 4"	8' 6"	6' 2"	9,175	1,595	10,750	1,575	52	82*	45	4-6
30CRT	34' 3"	8' 1"	12' 3"	8' 5"	6' 2"	9,565	1,845	11,500	1,935	52	82*	45	2-4
31MBT	37' 6"	8' 1"	12' 6"	7' 11"	6' 2"	10,685	2,055	12,750	2,065	52	82*	45	5-7
31QCD	36' 8"	8' 1"	12' 6"	7' 11"	6' 2"	9,817	2,215	11,700	1,883	52	82*	45	5-7

Meet your Jayco Dealer



Scan QR code for specification definitions

Some specs at the time of print may include estimates. For the most updated information, please visit Jayco.com

Jayco, Inc. | P.O. Box 460 | Middlebury, IN 46540

See dealer for further information and prices. All information in this brochure and on www.jayco.com is the latest available at the time of publication approval. Jayco reserves the right to make changes and to discontinue models without notice or obligation. Photography may show optional equipment or props used for decoration purposes only. RVs built for sale in Canada may differ to conform to Canadian codes. JAYCO and the JAYCO BIRD IN FLIGHT are registered trademarks of Jayco, Inc. Printed in USA 11/24 ©2024 Jayco, Inc. 2032974



Jayco - Part of Jayco Family of Companies